

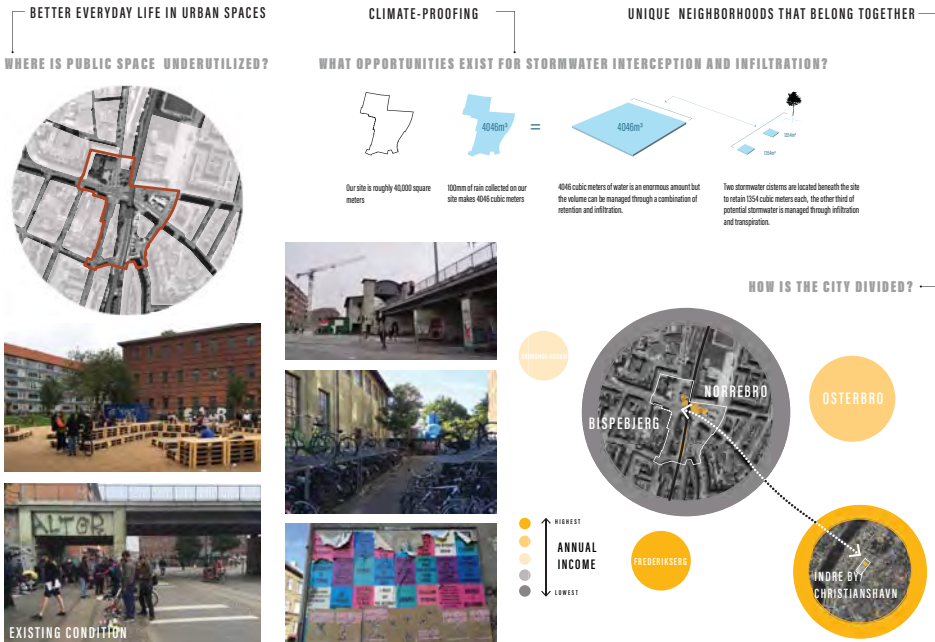

JACK ALDERMAN \\\ JIAN SHAN \\\ KEVIN VAN METER \\\ TATYANA VASHCHENKO
LA 501 ECOLOGICAL URBANISM

CO-CREATE COPENHAGEN: a **LIVEABLE, RESPONSIBLE, CITY** with an **EDGE**



EXTENDING THE EDGE

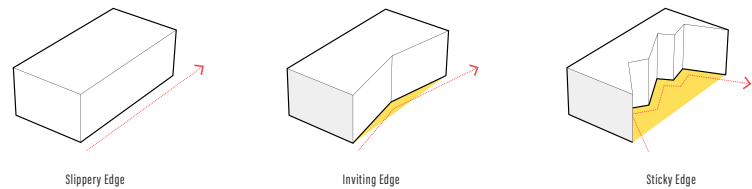

TASKS

1) Focus Together

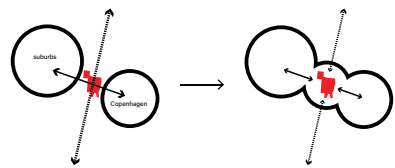

2) Connect Across the Railway

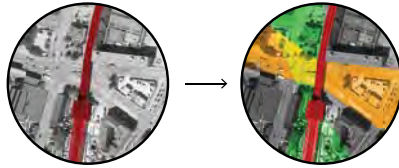

3) Engage People—Powered Transit

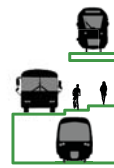

PLANTING

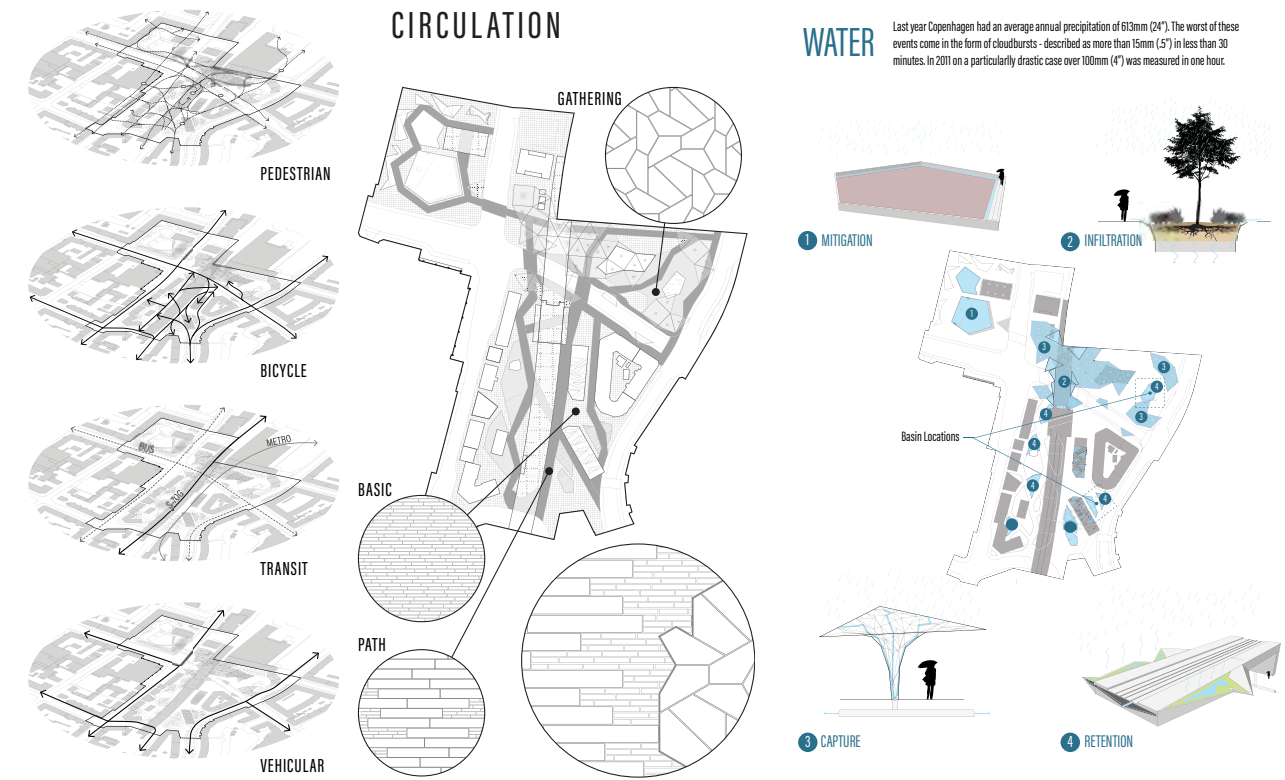
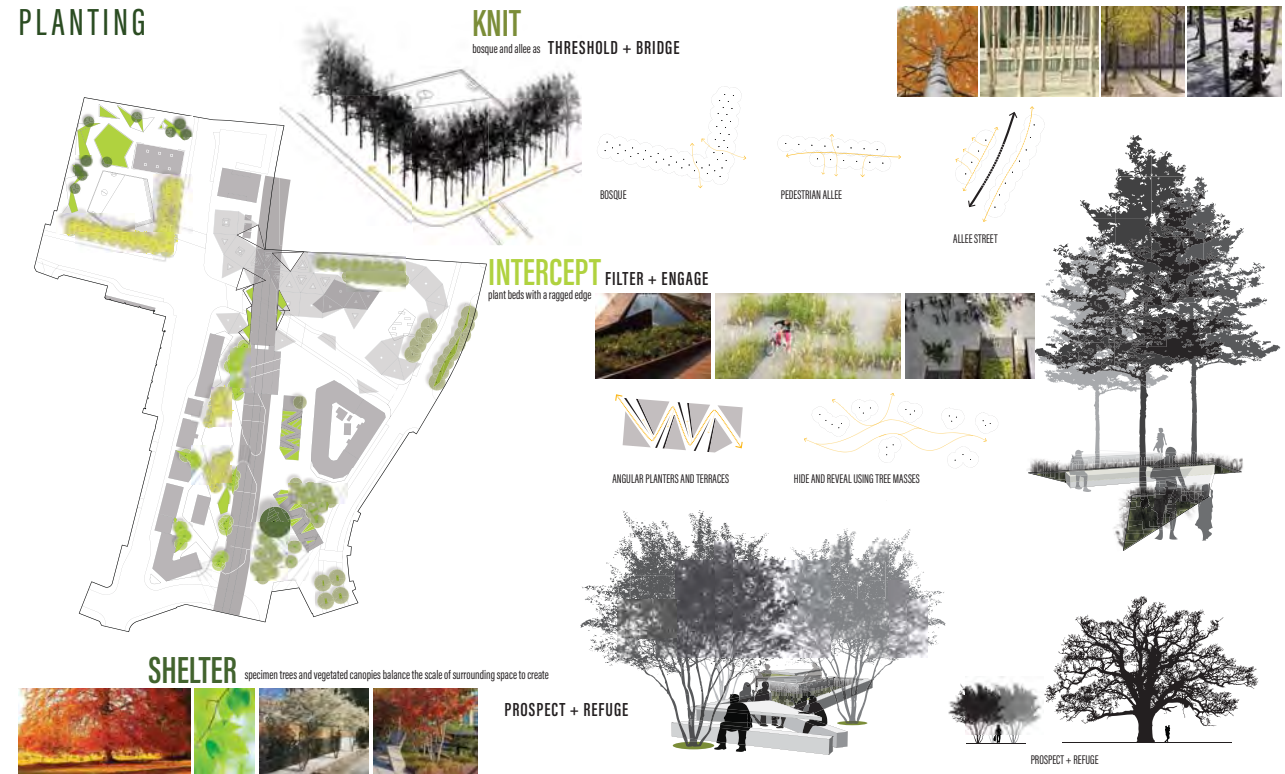

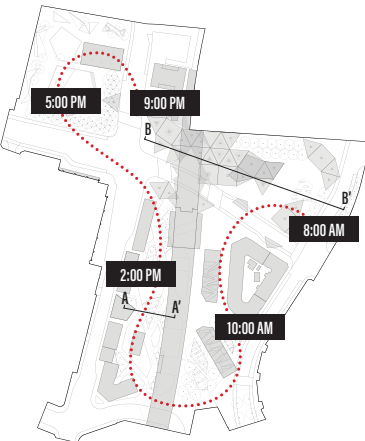

8:00 AM - We watch students and commuters heading out on bike or toward transit. Vendors set up for the daily market beneath the canopy. The East side of the market is the place to go for prepared food, produce, dairy and meat. Catch some cool morning air by the mist fountain.

10:00 AM - We follow the commuters across Nørrebrogade toward the transit hub. The morning rush has slowed, but people are still moving through. This site accesses bus, metro, and train transportation and is accommodated for such. It is defined by raised buildings at the north and south ends of the area. These buildings provide easy access to the metro as well as additional bike parking above and below grade.

2:00 PM - Passing beneath the elevated train tracks we arrive at the promenade. A broad path stretches before us, angling between buildings. Oases of trees and lively building thresholds catch our attention as we walk along. Notice the shops beneath the bridge, incubators for local artisans.

5:00 PM - We head back across Nørrebrogade to the refuge. Located in a space split by two apartment buildings this is the place to go for a quiet walk or picnic. An alley of birch trees edges the park, a soft permeable boundary. Inside we find the sunken play court that doubles as a safety measure for cloudbursts, keeping the residential building safe from water.

9:00 PM - Turning east brings us back to the market. The West side of the market has a strong connection to the promenade and has more local vendors selling arts or crafts. The structure of the canopy comes alive at night with lights. The market is bustling with people from all across Copenhagen.

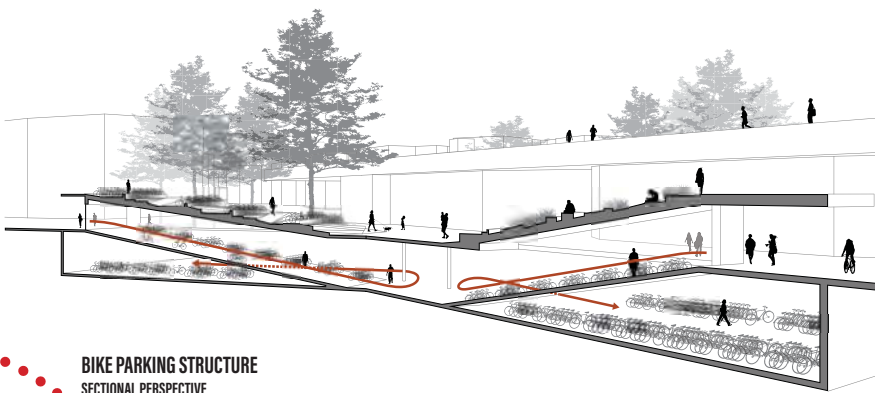

BIKE PARKING STRUCTURE
SECTIONAL PERSPECTIVE

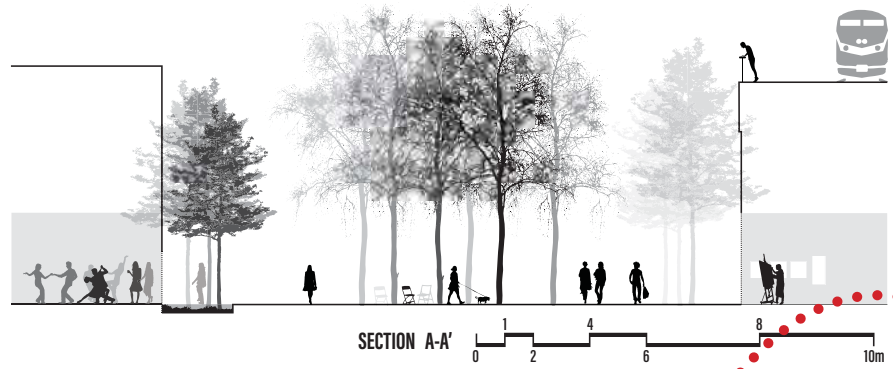

SECTION A-A'

REFUGE
SEASONAL PERSPECTIVE

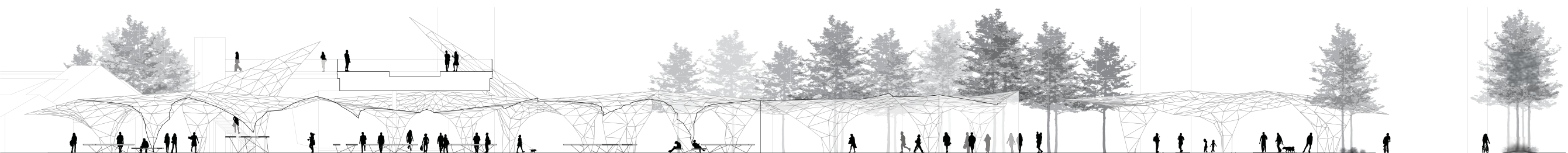
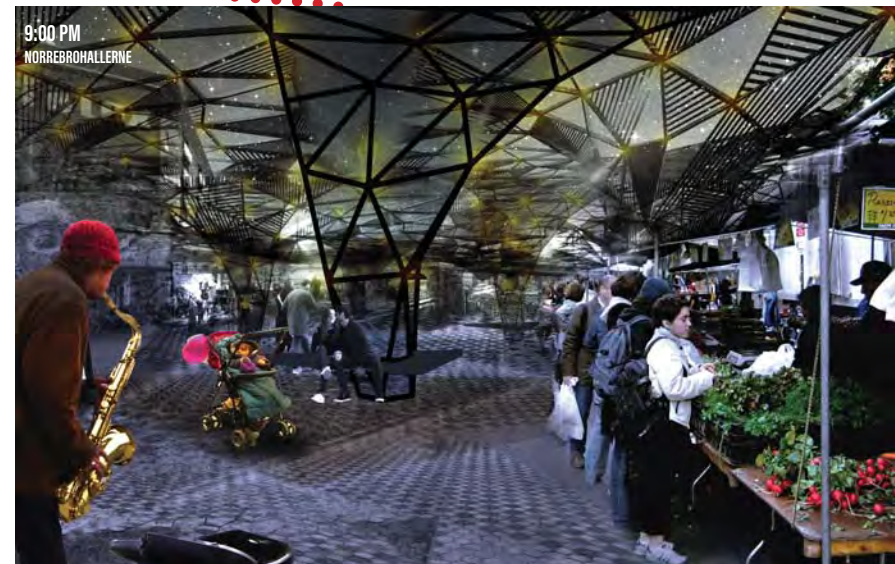

SECTION B-B'