



Image: DAC & LIFE Website

Bananna Park: bird's-eye view of the Banana

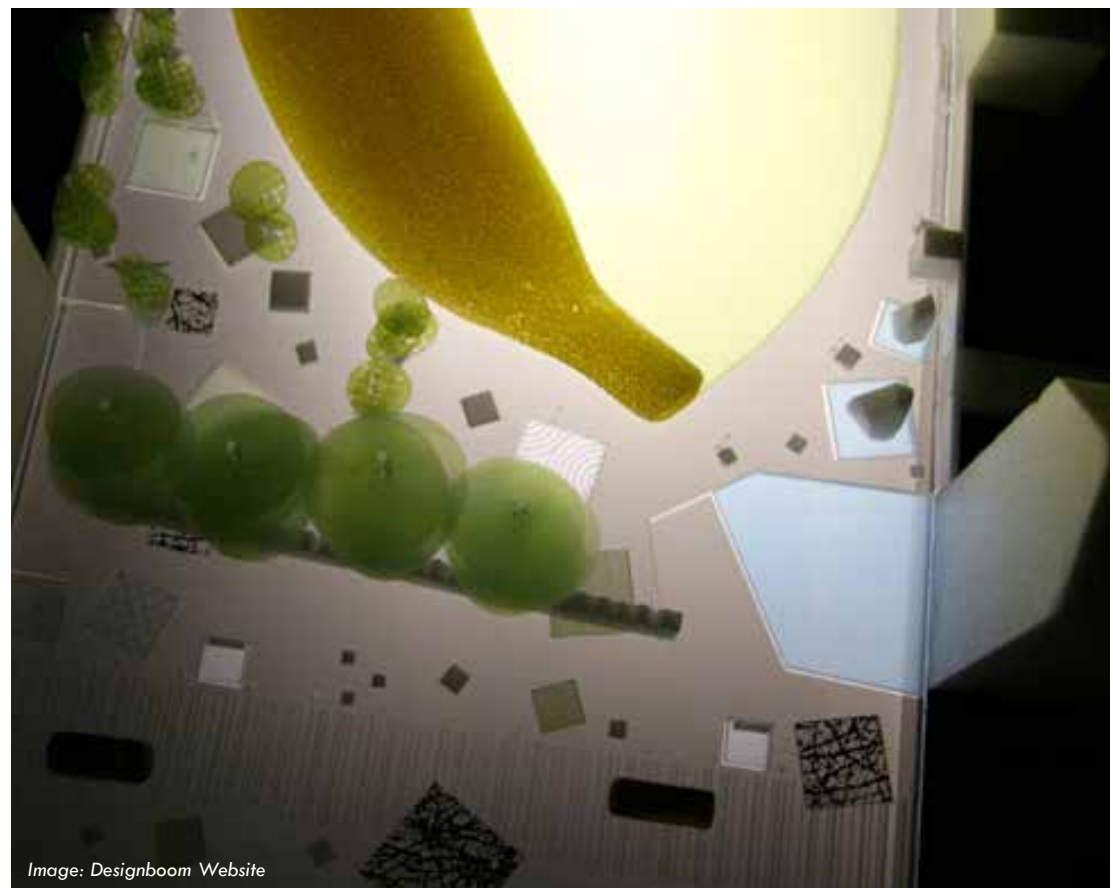

Image: Designboom Website

Model

BANANNA PARK

Study by Guanyi Gao + Youngsuk Jun

BaNanna Park was conceived as a Local Green Haven. This project is meaningful because it secured green space in one of Denmark's least green urban areas. In late 2004 news of a plan to build a housing estate on an unbuilt and overgrown pocket of land at Nannasgade in Nørrebro were made public. Parents and staff at the Rådmandsgade School along with local community members quickly gathered 2,300 signatures in a petition against the project, which eventually led to the BaNana Park project.

Before the face lift, Nannasgade was called "the contaminated site" because of the oil refinery that used to be there. The site was cleaned up to create safer place for children to play in the park, and the name was also changed to the more cheerful BaNanna Park.



Image: DAC & LIFE Website

The Jungle



Image: DAC & LIFE Website

The Square



Image: DAC & LIFE Website

The Lawn



Image: Designboom Website

Plan



Google Maps, 2013

■ SITE: Nørrebro, Copenhagen, Denmark